

## Product Description

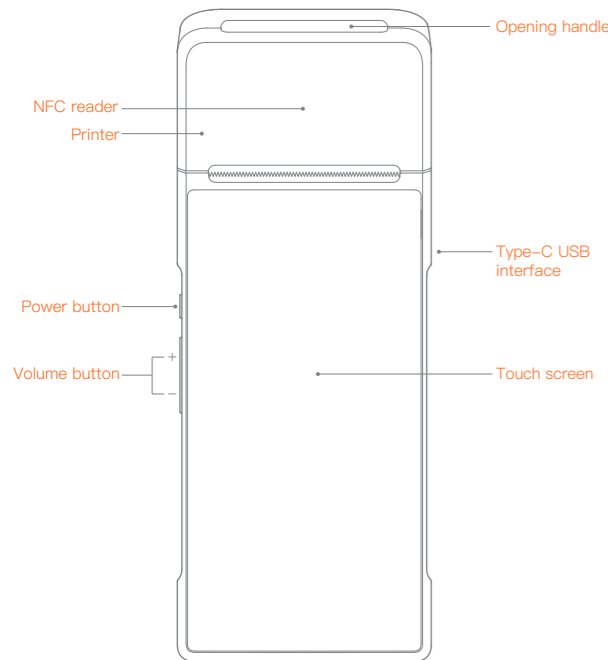

### Power button

Short press: wake up the screen, lock the screen.  
Long press: long press for 2-3 seconds in power off mode to switch on the device.  
Long press for 2-3 seconds in normal operation mode to select power off or reboot.  
Long press for 11 seconds when system is frozen for automatic reboot.

### Volume button

Volume adjustment (with app support, the button can be set as quick code scan button).

### Printer

For printing sales slips in power on mode.

### NFC reader

Be used for NFC cards like loyalty card.

### Type-C interface

For device recharging and developer debugging.

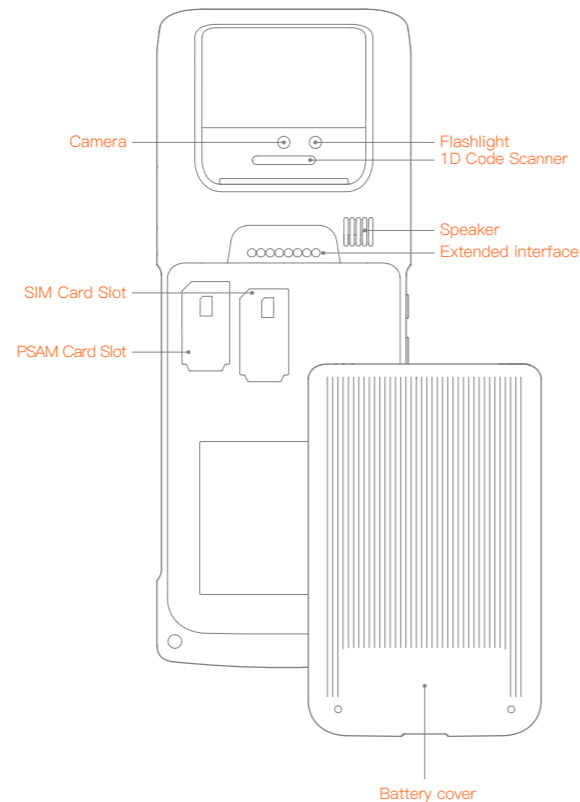

### Camera

Supports photographing and 1D/2D code quick scanning.

### PSAM Card Slot

Used for inserting the PSAM Card.

### SIM Card Slot

Note: To prevent system errors, please make sure the device is turned off when you insert or remove the SIM card.

### 1D Code Scanner

The 1D Code Scanner is used for reading product bar codes and mobile payment code.  
(This Scanner only supports 1D bar codes)

Note: don't look straight at the Infrared scanning head to avoid eye injuries.

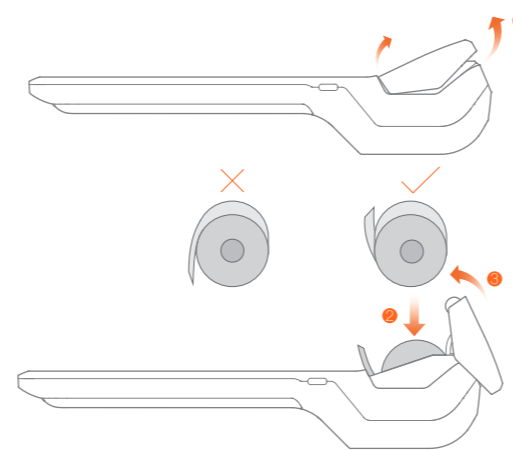

### Printing instructions

This device supports 58mm thermal paper with the specifications of  $57\pm 0.5\text{mm} \times \varnothing 40\text{mm}$

- Please open the paper container with the uncovering handle (as shown in Fig.1). Please do not force open the paper container to avoid print head gear wear;
- Feed the paper correctly into the paper container in the direction as shown, and pull some paper outside the cutter (as shown in Fig.2);
- Close the cover of the paper container to finish printing paper feeding (as shown in Fig.3).

Note: If the printed paper is blank, please check whether the paper roll has been installed in the correct direction.

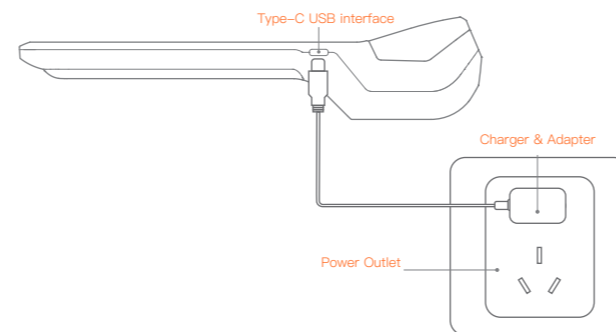

### Instructions for recharging and battery

This device supports charging only by USB cable

- Connect the 5V adapter to the power supply socket;
- Connect the USB cable to the USB interface of the device for recharging;
- The screen will display the recharging icon during the recharging process;
- If the recharging icon does not appear, please check whether the USB interface is well connected.

### Instructions/Notes for battery

- This device adopts 7.6V/2580mAh lithium battery; please do not disassemble the battery.
- In order to protect the battery life, we recommend that you recharge the device whenever possible, and please do not allow the battery to fully drain before recharging.

## Extremely easy settings

Only a few steps to activate an intelligent business device

- Set 2G/3G/4G: when power off, insert the 2G/3G/4G card and then power on. (Refer to the Technical Specifications for the support of cards)
- Long press the Power Key for 2-3s to activate the backlight of screen, and then operate following the prompts after entering the startup/booting screen for the first time. 2 modes for accessing the Internet are available.
- Set WiFi
  - Click "Set" button, activate "WLAN" to enter the WLAN searching screen, and wait it to list all useable WLAN hot spots;
  - Click the WLAN to be connected, and enter the access password in case of an encrypted network.

### Download/use Apps

After connected to the Internet, open the App Market, find, download and install the Apps.

## FAQ

### Booting failure (e.g. low battery)

- Plug the USB cable and charge for 3min;
- Check if the screen displays the normal charging status.

### System crash

- Long press the Power Key for 11s to reboot.

### Read the installed Help App for more information

## Precautions

### Safety Warning

- Connect the AC plug to the AC socket corresponding to the marked input of the power adapter;
- Do not use in the presence of any potentially explosive gas;
- To avoid injury, unauthorized persons shall not open the power adapter;
- This is a Class A product. This product may cause radio interference in living environments. In that case, the user may be required to take adequate measures against interference.
- Battery replacement:
  - Explosion danger may arise if replacing with the wrong battery!
  - The replaced battery shall be disposed of by maintenance personnel, and please do not throw it into fire!

### Significant Safety Instructions

- This terminal is a handheld device, and the user shall protect the password from being peered at by others while entering the password;
- Do not install or use the device during lightning storms to avoid the potential risks of lightning shock;
- Please turn off the power immediately if you notice abnormal odor, heat or smoke;
- The paper cutter is sharp, please do not touch!

### Suggestions

- Do not use the terminal near water or moisture to prevent liquid from falling into the terminal;
- Do not use the terminal in extremely cold or hot environments, such as near flames or lit cigarettes;
- Do not drop, throw or bend the device;
- Use the terminal in a clean and dust-free environment if possible to prevent small items from falling into the terminal;
- Please do not use the terminal near medical equipment without permission.

### Statements

The Company does not assume responsibilities for the following actions:

- Damages caused by use and maintenance without complying with the conditions specified in this guide;
- The Company will not assume any responsibilities for the damages or problems caused by optional items or consumables (rather than the initial products or approved products of the Company). The customer is not entitled to change or modify the product without our consent.
- The product's operating system supports official system updates, but if you change the operating system into a third party ROM system or alter the system files by system cracking, it may cause system instability and security risks and threats.

### Disclaimer

As a result of product upgrading, some details in this document may not match the product, and the actual product shall govern. The Company reserves the right of interpretation of this document. The Company also reserves the right to alter this specification without prior notice.

## Technical specifications

Item	Technical Specifications
Operating system	Android 7.1
CPU basic frequency	1.4GHZ four cores
RAM	1GB LPDDR3
FLASH	8GB Nand Flash
Display	5.99 inch IPS, resolution 1440×720
Touch screen	Capacitive two-touch screen
Camera	500W AF
Wireless data	2G: B3(EGSM900)/B8(DCS1800) 3G: wcdma(B1/B8) 4G: B1/B3/B7/B20/B38/B40
Wi-Fi	Build-in Wi-Fi 802.11a/b/g/n(2.4G/5G)
Bluetooth	Support of bluetooth 3.0/4.2BLE and iBeacon
Keys	Power key, volume key
Interfaces	Configuration interfaces Type-c, SIM, PSAM, support of OTG
Printer type	Thermal Printer
Printing paper specifications	Width 58mm, maximum diameter 40mm
NFC	mifare/ISO 14443 Type A/B/ISO15693
Battery	7.6V/2580mAh
Outline dimensions	L 214mm × W 83mm × H 49mm
Adapter	OUTPUT: DC5V/2A INPUT: AC100~240V/0.3A 50/60Hz
Adapter Model	TPA-05A050200BU1 TPA-46050200VU

### CE certification information (SAR)

This device was tested for typical body-worn operations with the back of the handset kept 0mm away. To maintain compliance with RF exposure requirements, use accessories that maintain a 0mm separation distance between the user's body and the back of the handset. The use of belt clips, holsters and similar accessories should not contain metallic components in its assembly. The use of accessories that do not satisfy these requirements may not comply with RF exposure requirements, and should be avoided.

If you are using pacemaker, hearing aid, cochlear implant or other device, please use the phone according to the doctor's advice.

### PRODUCT SAFETY WARNINGS

Use responsibly. Read all instructions and safety information before use to avoid injury. The limit operating ambient temperature of the equipment declared by the manufacturer is -10~45°C

#### Battery safety

Charge battery only at ambient temperatures ranging from 40°C.

(1) CAUTION: Danger of explosion if battery is incorrectly replaced.

Replace only with the same or equivalent type of battery recommended by the manufacturer. Dispose of used batteries according to battery manufacturer's instructions.

(2) CAUTION: RISK OF EXPLOSION IF BATTERY IS REPLACED BY AN INCORRECT TYPE. DISPOSE OF USED BATTERIES ACCORDING TO THE INSTRUCTIONS.

(3) CAUTION: Battery charging temperature upper limit is 40°C.

#### Adapter safety

When charging, please place the device in an environment that has a normal room temperature and good ventilation. It is recommended to charge the device in an environment with a temperature that ranges from 0°C~40°C.

For altitude 2km below use only

#### Camflash safety

LED is only used as indicating light.

#### Wi-Fi Safety

Turn Wi-Fi off in areas where Wi-Fi use is prohibited or when it may cause interference or danger, such as in airplanes while flying.

### Declaration of Conformity



BE	BG	CZ	DK
DE	EE	IE	EL
ES	FR	HR	IT
CY	LV	LT	LU
HU	MT	NL	AT
PL	PT	RO	SI
SK	FI	SE	UK

Hereby, Shanghai Sunmi Technology Co., Ltd. declares that the Wireless data POS System(Model No.:T5921) is in compliance with the essential requirements and other relevant provisions of RED 2014/53/EU.

CAUTION: The user has to turn off the 5GHz WiFi in outdoor environment.

5.8G SRD receiver category: 1

### Technical features and characteristic

	Operation Frequency	Transmitted
GSM900	880MHz~915MHz	27.1dBm (GPRS)
		25.4dBm (EGPRS)
GSM1800	1710MHz~1785MHz	22.7dBm (GPRS)
		23.6dBm (EGPRS)
WCDMA bandI	880MHz~915MHz	22.19dBm
WCDMA bandVIII	1920MHz~1980MHz	23.04dBm
LTE band1	1920MHz~1980MHz	22.9dBm
LTE band3	1710MHz~1785MHz	22.8dBm
LTE band7	2500MHz~2570MHz	22.2dBm
LTE band20	832MHz~862MHz	22.7dBm
LTE band38	2570MHz~2620MHz	22.9dBm
LTE band40	2300MHz~2400MHz	22.8dBm
WIFI	2412MHz~2472MHz	18.1dBm E.I.R.P
	5150MHz~5250MHz	11.1dBm E.I.R.P
SRD	5725MHz~5850MHz	12.37dBm E.I.R.P
BT	2402MHz~2480MHz	7.5dBm E.I.R.P
NFC	13.56MHz	-15.20dBuA/m at 10m
GPS	1575.42MHz	

### Name and content of toxic and harmful substances

contained in this product are shown in the following table

Name of parts	Toxic and harmful substances and elements					
	(Pb)	(Hg)	(Cd)	(Cr(VI))	(PBB)	(PBDE)
Circuit board	×	○	○	○	○	○
Shell	○	○	○	○	○	○

○:It indicates that the content of toxic and harmful substances in all homogeneous materials of this part is below the limit specified in SJ/T11363-2006.

×:It indicates that the content of toxic and harmful substances is higher than the limit specified in SJ/T11363-2006 in at least one homogeneous material of this part; however, the the reason why the toxic substance of that part exceeds the limit is that there is no applicable material to replace it currently.

For products that have reached or passed the service years for environmental protection, they should be recycled according to Measures for Control and Management of Electronic Information Products and should not be thrown away at will.

This product can be used across EU member states. The full text of the EU declaration DOC is available at the following internet address: www.sunmi.com

#### Manufacture

Room 505 No.388 Song Hu Road Shanghai, China

# V2 PRO

## User Guide T5921

### List of packaged items

- Terminal device × 1
- User's Guide × 1
- Charger & Adapter × 1
- USB Cable × 1

\_\_\_\_\_